

User's Guide to NMR, 2021 Without Autosampler: Draft 11/4/2025. Help: Dr. Jasperse, Hagen 407J, 477-2230

1. **Prepare sample** in lab; **add sample to sample-holder**; adjust sample depth using **golden depth finder**
2. **Eject/Insert** (Sample Exchange):
 - a. Hit **"eject"** button (below black field) to eject existing sample. (If not visible, click "start" button to make it so)
 - b. **Manually lift out sample-in-sample-holder** combination from the probe (place it in a box)
 - c. **Place your sample-in-sample-holder** into the probe
 - d. Hit **"insert"** button on the computer. (Wait ≥ 5 seconds before proceeding with step 3a).

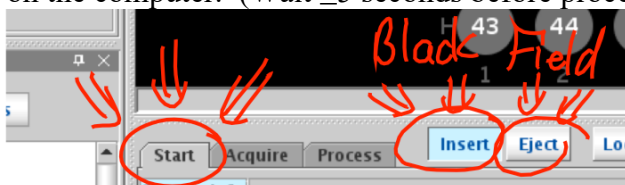

3. **Spot Assignment:** (Each sample needs to be assigned a sample spot number)
 - a. **Right-click** on the lowest-numbered gray spot number in the zones map. (A pulldown will appear)
 - b. Select **"Sample in Magnet"** (3rd line from the bottom of the pulldown);
 - c. **Enter your spot number** into the upper field. (Remember your spot number)
 - d. Hit **OK**.

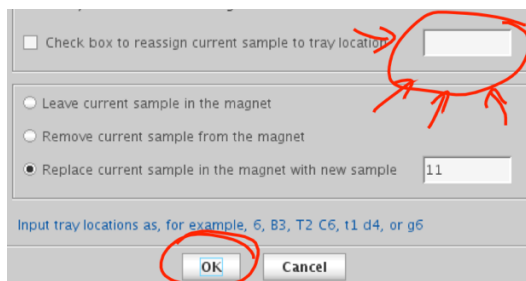
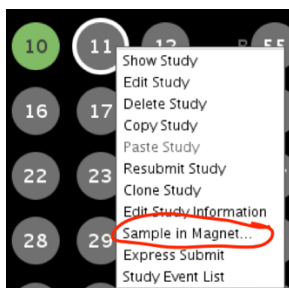

4. **NMR-Experiment Submission:**
 - e. Click **"New Study"** button in lower left. (A yellow experiment file-name will appear).
 - f. The default experiment is **"Proton-8"**; for something different select from panel on upper left.
 - g. **Left-mouse single-click** on your sample spot. (A white circle will appear around the sample spot)
 - h. Enter student name(s) into **Sample Name** field, which is underneath the black field
 - i. Submit: click the **green "Submit"** button on the lower left side. (your sample spot should turn color)
 - j. Hit **"Cancel"** to leave submit-sample mode.
 - a. Don't forget to do this. If you do, it will cause problems for both you and the ensuing user.
 - b. The yellow experiment file-name will disappear; unfortunately the zones map will too.
 - k. Re-open "zones" map: **Click on little circle icon** (⚙️) to the upper left of the big gray/black panel, and the zones map with all the sample spot numbers should re-open.
 - Note: An experiment should take about 7 minutes.
 - There should be an automatic one-page printout upon completion.

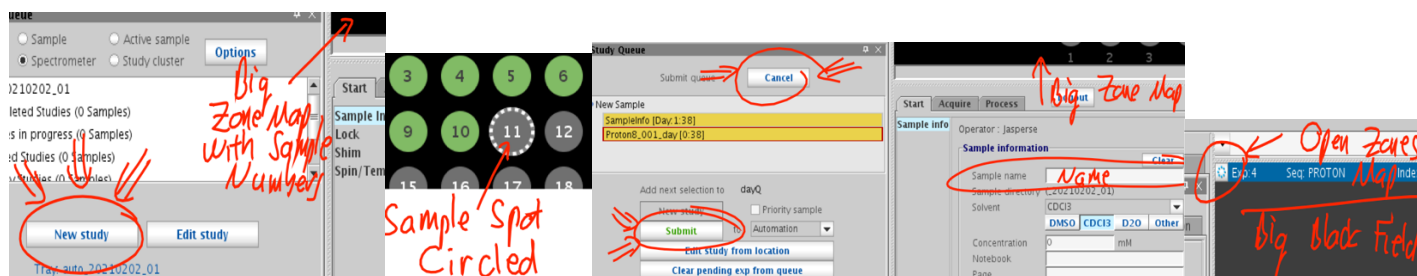

5. **Printing an extra copy** of spectrum (in case you have a partner)
- Must be in zones-map display. If not, click on little circle icon (⚙️) upper left of the spectra-display panel.
 - a. **Right click on sample number**, and a pulldown will appear
 - b. Click "Show Study"
 - c. **Double click on green "PROTON_01"** file that will appear in the lower left-hand area. (below your name)
 - a. Your spectrum should now appear in the display field, where the zones-map appeared before
 - d. Click "**Process**" button underneath the spectrum display field. ("Start" was highlighted previously)
 - e. Click blue-text-on-white-background "**Print**" button on lower right to print another copy.



6. Horizontal Expansions

- a. Steps 5a-d above describe how to get your spectrum loaded into the display field.
- b. With spectrum displayed on screen, **use a panel of display icons on the far upper right**
- c. Click on the **magnifying glass icon (6th icon down, 🔍)**
- d. Move your cursor to the left end of the zone you want to expand, then **hold down left mouse button and slide it** to the other end of the zone you want to expand, then release the button.
 - a. To return to the full display, you can either click on the 3rd icon (⏪) or the 5th icon (🔍).
- f. Click blue-text-on-white-background "**Print**" button on lower right to print a copy. (Twice for 2 copies)

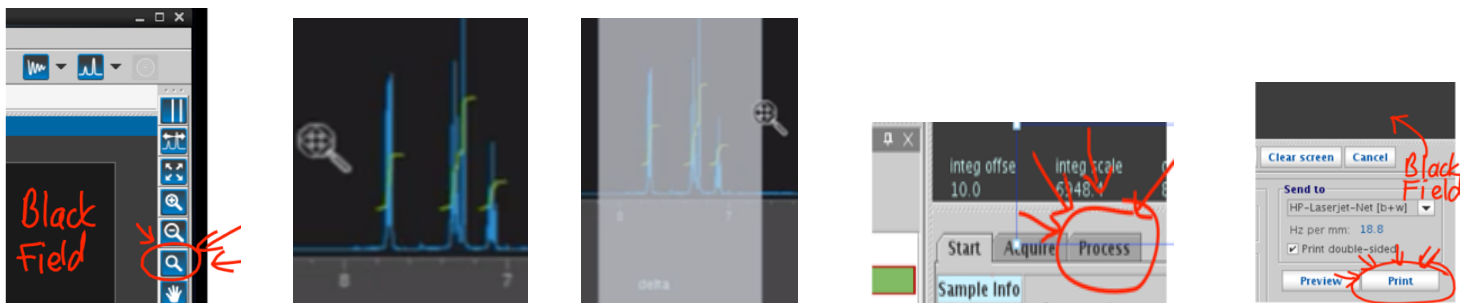

7. Exiting so that NMR is Ready for the Next user

- a. Click "**Start**" button underneath the spectrum display field. ("Process" was highlighted previously)
- b. Re-open "zones" map: **Click on little circle icon (⚙️)** to the upper left of the big gray/black panel, and the zones map with all the sample spot numbers should re-open.

